

Ponto	Asimuta	Distância	(X)	(Y)
BRV-0-000	BRV-0-001	13911,31	288.813,54	7412.518,53
BRV-0-000	BRV-0-002	13873,78	288.844,315	7412.518,98
BRV-0-000	BRV-0-003	13757,21	288.869,074	7412.528,917
BRV-0-000	BRV-0-004	14021,49	288.871,688	7412.538,728
BRV-0-000	BRV-0-005	14427,10	288.882,362	7412.571,819
BRV-0-000	BRV-0-006	14727,10	288.887,895	7412.628,033
BRV-0-000	BRV-0-007	14978,10	288.891,430	7412.698,087
BRV-0-000	BRV-0-008	15177,45	288.893,862	7412.783,024
BRV-0-000	BRV-0-009	15325,26	288.895,294	7412.881,961
BRV-0-000	BRV-0-010	15432,10	288.895,726	7412.992,898
BRV-0-000	BRV-0-011	15500,00	288.895,158	7413.115,835
BRV-0-000	BRV-0-012	15530,00	288.894,590	7413.250,772
BRV-0-000	BRV-0-013	15530,00	288.894,022	7413.397,709
BRV-0-000	BRV-0-014	15500,00	288.893,454	7413.555,646
BRV-0-000	BRV-0-015	15450,00	288.892,886	7413.724,583
BRV-0-000	BRV-0-016	15380,00	288.892,318	7413.903,520
BRV-0-000	BRV-0-017	15290,00	288.891,750	7414.092,457
BRV-0-000	BRV-0-018	15180,00	288.891,182	7414.291,394
BRV-0-000	BRV-0-019	15050,00	288.890,614	7414.500,331
BRV-0-000	BRV-0-020	14900,00	288.890,046	7414.719,268
BRV-0-000	BRV-0-021	14730,00	288.889,478	7414.948,205
BRV-0-000	BRV-0-022	14540,00	288.888,910	7415.187,142
BRV-0-000	BRV-0-023	14330,00	288.888,342	7415.435,079
BRV-0-000	BRV-0-024	14100,00	288.887,774	7415.691,016
BRV-0-000	BRV-0-025	13850,00	288.887,206	7415.954,953
BRV-0-000	BRV-0-026	13590,00	288.886,638	7416.226,890
BRV-0-000	BRV-0-027	13320,00	288.886,070	7416.506,827
BRV-0-000	BRV-0-028	13040,00	288.885,502	7416.794,764
BRV-0-000	BRV-0-029	12750,00	288.884,934	7417.090,701
BRV-0-000	BRV-0-030	12450,00	288.884,366	7417.394,638
BRV-0-000	BRV-0-031	12140,00	288.883,798	7417.706,575
BRV-0-000	BRV-0-032	11820,00	288.883,230	7418.026,512
BRV-0-000	BRV-0-033	11490,00	288.882,662	7418.354,449
BRV-0-000	BRV-0-034	11150,00	288.882,094	7418.690,386
BRV-0-000	BRV-0-035	10800,00	288.881,526	7419.034,323
BRV-0-000	BRV-0-036	10440,00	288.880,958	7419.386,260
BRV-0-000	BRV-0-037	10080,00	288.880,390	7419.746,197
BRV-0-000	BRV-0-038	9720,00	288.879,822	7420.113,134
BRV-0-000	BRV-0-039	9360,00	288.879,254	7420.486,071
BRV-0-000	BRV-0-040	9000,00	288.878,686	7420.864,008
BRV-0-000	BRV-0-041	8640,00	288.878,118	7421.246,945
BRV-0-000	BRV-0-042	8280,00	288.877,550	7421.633,882
BRV-0-000	BRV-0-043	7920,00	288.876,982	7422.025,819
BRV-0-000	BRV-0-044	7560,00	288.876,414	7422.422,756
BRV-0-000	BRV-0-045	7200,00	288.875,846	7422.824,693
BRV-0-000	BRV-0-046	6840,00	288.875,278	7423.231,630
BRV-0-000	BRV-0-047	6480,00	288.874,710	7423.643,567
BRV-0-000	BRV-0-048	6120,00	288.874,142	7424.060,504
BRV-0-000	BRV-0-049	5760,00	288.873,574	7424.482,441
BRV-0-000	BRV-0-050	5400,00	288.873,006	7424.909,378
BRV-0-000	BRV-0-051	5040,00	288.872,438	7425.341,315
BRV-0-000	BRV-0-052	4680,00	288.871,870	7425.778,252
BRV-0-000	BRV-0-053	4320,00	288.871,302	7426.220,189
BRV-0-000	BRV-0-054	3960,00	288.870,734	7426.667,126
BRV-0-000	BRV-0-055	3600,00	288.870,166	7427.118,063
BRV-0-000	BRV-0-056	3240,00	288.869,598	7427.572,999
BRV-0-000	BRV-0-057	2880,00	288.869,030	7428.030,936
BRV-0-000	BRV-0-058	2520,00	288.868,462	7428.492,873
BRV-0-000	BRV-0-059	2160,00	288.867,894	7428.958,810
BRV-0-000	BRV-0-060	1800,00	288.867,326	7429.428,747
BRV-0-000	BRV-0-061	1440,00	288.866,758	7429.902,684
BRV-0-000	BRV-0-062	1080,00	288.866,190	7430.380,621
BRV-0-000	BRV-0-063	720,00	288.865,622	7430.862,558
BRV-0-000	BRV-0-064	360,00	288.865,054	7431.348,495
BRV-0-000	BRV-0-065	0,00	288.864,486	7431.838,432

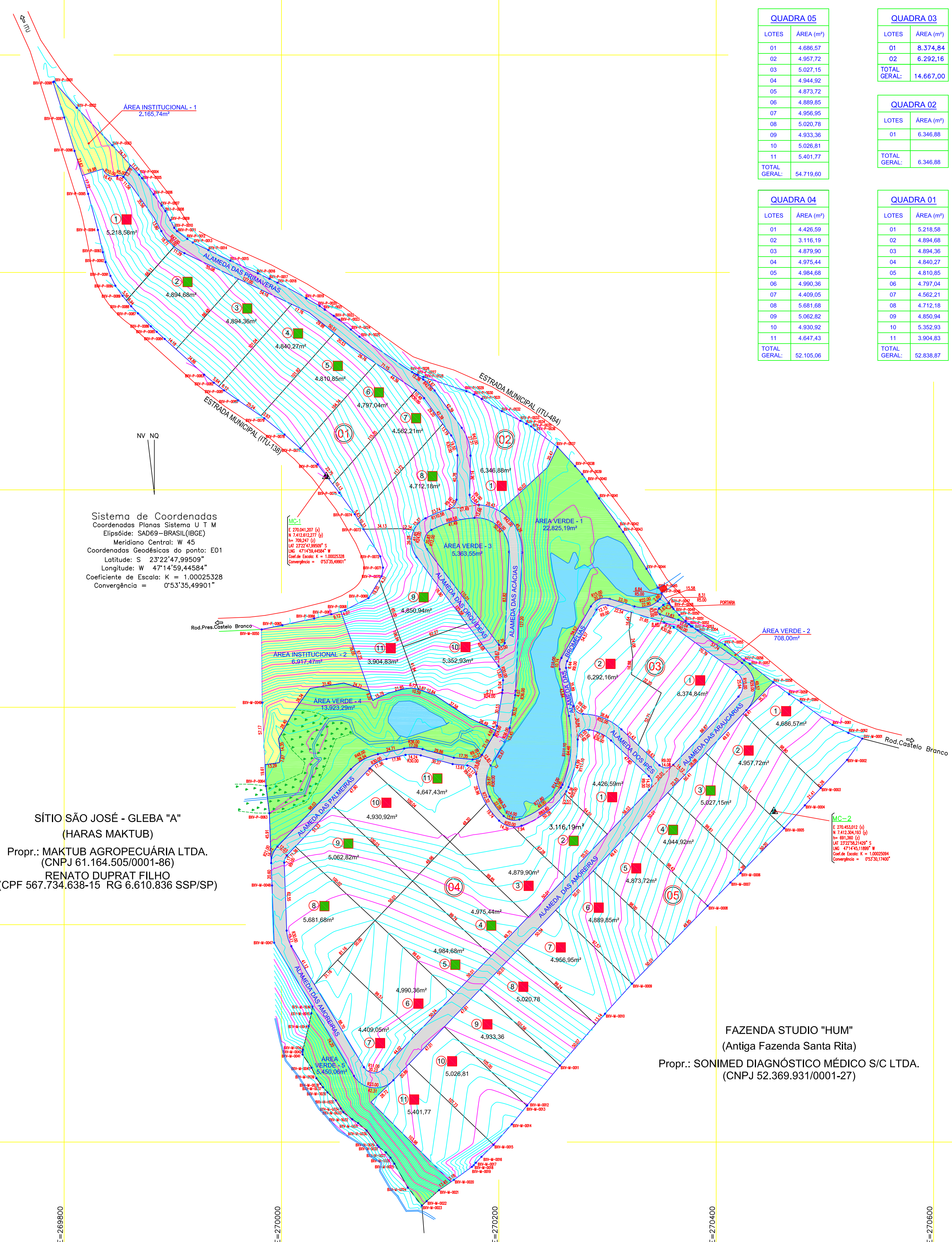

Sistema de Coordenadas
 Coordenadas Planas Sistema U T M
 Elipsóide: SAD69-BRASIL (IGGE)
 Meridiano Central: W 45
 Coordenadas Geodésicas do ponto: E01
 Latitude: S 23°22'47,99509" S
 Longitude: W 47°14'59,44584" W
 Coeficiente de Escala: K = 1,00025328
 Convergência = 0°53'35,49901"

SÍTIO SÃO JOSÉ - GLEBA "A"
 (HARAS MAKTUB)
 Prop.: MAKTUB AGROPECUÁRIA LTDA.
 (CNPJ 61.164.505/0001-86)
 RENATO DUPRAT FILHO
 (CPF 567.734.638-15 RG 6.610.836 SSP/SP)

FAZENDA STUDIO "HUM"
 (Antiga Fazenda Santa Rita)
 Prop.: SONIMED DIAGNÓSTICO MÉDICO S/C LTDA.
 (CNPJ 52.369.931/0001-27)

QUADRA 05

LOTES	ÁREA (m²)
01	4.686,57
02	4.957,72
03	5.027,15
04	4.944,92
05	4.873,72
06	4.899,85
07	4.956,95
08	5.020,78
09	4.933,36
10	5.026,81
11	5.401,77
TOTAL GERAL:	54.719,60

QUADRA 03

LOTES	ÁREA (m²)
01	8.374,84
02	6.292,16
TOTAL GERAL:	14.667,00

QUADRA 02

LOTES	ÁREA (m²)
01	6.346,88
TOTAL GERAL:	6.346,88

QUADRA 01

LOTES	ÁREA (m²)
01	5.218,58
02	4.894,68
03	4.894,36
04	4.840,27
05	4.810,85
06	4.797,04
07	4.409,05
08	5.681,68
09	4.850,94
10	5.352,93
11	3.904,83
TOTAL GERAL:	52.838,87

QUADRA 04

LOTES	ÁREA (m²)
01	4.426,59
02	3.116,19
03	4.879,90
04	4.975,44
05	4.984,68
06	4.990,36
07	4.409,05
08	5.681,68
09	5.062,82
10	4.930,92
11	4.647,43
TOTAL GERAL:	52.105,06

(QUADRAS/LOTES)

DESCR.	ÁREA (m²)	Nº DE LOTES
QUADRA-05	54.719,60	11
QUADRA-04	52.105,06	11
QUADRA-03	14.667,00	2
QUADRA-02	6.346,88	1
QUADRA-01	52.838,87	11
TOTAL GERAL	180.677,41	36

ÁREAS DE PÚBLICAS

DESCR.	ÁREA (m²)
ÁREA VERDE-1	22.825,19
ÁREA VERDE-2	708,00
ÁREA VERDE-3	5.363,55
ÁREA VERDE-4	13.923,29
ÁREA VERDE-5	5.450,06
ÁREA INST-1	2.165,74
ÁREA INST-2	6.917,47
TOTAL GERAL	57.353,31

ÁREA DE ARRUIAMENTO

DESCR.	ÁREA (m²)
AL.DAS ORDIDEAS	2.322,65
AL.DAS MOREIRAS	8.421,82
AL.DOS IPÊS	1.423,71
AL.ARAUCÁRIAS	2.411,08
AL.BROMÉLIAS	2.443,40
AL.AÇACIAS	3.142,10
AL.PALMEIRAS	2.199,47
AL.DAS PRIMAVERAS	5.612,57
TOTAL GERAL	27.976,80

LEGENDA

- Lote Ocupado
- Lote Desocupado

